

SPECIALLY DEVELOPED FOR PROFESSIONALS



READY TO USE

One part, neutral cure that quickly cures at room temperature by reaction with moisture in the air to produce 100 % silicone rubber.

FUNGUS & MILDEW RESISTANT

Fungus resistance has been tested in according to JIS-Z-2911

PERMANENTLY FLEXIBLE

Cured sealant is permanently flexible with life-expectancy of more than 20 years. (It will not crack, crumble or dry out.)

LONG LASTING WATERTIGHT & WEATHERPROOF

Cured sealant is unaffected by ozone, ultraviolet radiation and temperature extreme.

EXCELLENT ADHESION

Excellent adhesion to sheet metal, galvanised steel, most painted surfaces, anodized aluminium, glass, masonry, concrete, brick, ceramic, fibreglass and non-oily woods.

EXCELLENT ANTI-CORROSION BARRIER

Sx-2000s provides an excellent barrier between dissimilar metals where electrolytic corrosion can be a severe problem.

GOOD CHEMICAL RESISTANT

Resists attack from salt water, ultra-violet light, ozone, airborne pollutants, cleaning detergent, oil and most solvents.

MAIN APPLICATION

*Sanitary Fitting (include baths, & shower, sink, urinals and ceramic tile) and Kitchen.
Refrigerator.
Containers and Cold-Storage Room.
Clean Room.*

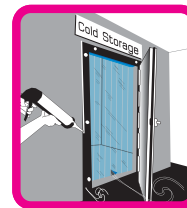
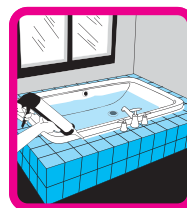
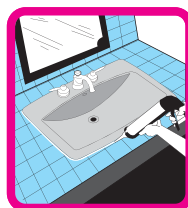
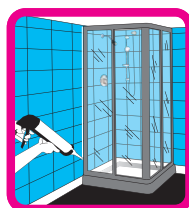

Sx-2000s

Sanitary & Cold/Clean Room Silicone Sealant

Sealex®

Professional • Professional • Professional • Professional • Professional • Professional • Professional

Sealex : Sx 2000s Sanitary & Cold/Clean Room Silicone Sealant is a high quality neutral cure silicone sealant specifically designed to provide high performance of mildew and fungus resistant. It quickly cures at room temperature by reaction with moisture in the air to produce durable, flexible seal that will not crack, crumble shrink or dry out. Cured sealant is unaffected by ozone, ultraviolet radiation and temperature extreme.

EXCELLENT ADHESION to most construction material such as metal, galvanised steel, zinc-coated metal building products, anodized aluminium, painted surfaces, glass, fibreglass, ceramic, fibrous cement, concrete, brick, masonry and non-oily woods.

NOT PAINTABLE LIMITATION Complete painting before applying sealant.
Sealex : Sx 2000s is not recommended for use in continuous water immersion nor for below ground or other joints where excessive abrasion and physical abuse are encountered.
It should not be applied to :
- Building material that bleeds oil or plasticizer.
- Totally closed area where sealant is not exposed to atmospheric moisture.
- Any uncured sealant apart from **Sealex : Sx 2000s**

DIRECTION

1. Ensure substrate surfaces are completely clean, dry and sound. Remove all grease, oil, dirt, detergent, any loose material and old sealant.
2. Mask both sides of joint if neat appearance is desired.
3. Cut tip off cartridge. Cut nozzle to desired width.
4. Apply sealant in continuous and steady flow ensuring both sides of joint is completely filled.
5. Tool off immediately before skin forms. Remove masking tape before sealant skins. Do not use soap or oil as a tooling aid.
6. Remove excess uncured sealant immediately with a cloth dampen with mineral turpentine.
7. Excess cured sealant is not soluble and must be trimmed with a blade.

STORAGE Store in a dry place below +30 °C

SHELF LIFE Use within 6 months from purchase.

CAUTION Uncured sealant may cause eye irritation. Avoid eye contact.

PACKAGING **Sealex : Sx 2000s** is supplied in 300 ml. disposable plastic cartridges. (25 cartridges in a carton.)

TYPICAL PROPERTIES

TYPE One part 100% silicone rubber.
CURING SYSTEM Neutral, moisture cure at room temperature. Will not cause corrosion to metal building component. Contains no solvent.

COLOURS Translucent, White

Uncured Sealant - Tested at at 25 °C and 50 % RH

TACK-FREE TIME	30 min. or less.
FLOW, SAG OR SLUMP	Non-sag.
WORKING TIME (TOOLING)	15 min. (Before sealant skin forms.)
CURING TIME (3 mm. BEAD)	24 hours
FULL ADHESION	7 days

Cured Sealant - After 7 days at 25 °C and 50 % RH

DUROMETER, SHORE A	26 points
TENSILE STRENGTH	1.3 Mpa
SERVICE TEMPERATURE	- 50 °C to + 150 °C
MOVEMENT CAPABILITY	± 25 %

Distributed by :



INNO-CONS COMPANY

inno-cons

www.inno-cons.com

Sealex®

SX-2000S